



KALAMAZOO COUNTY DRAIN COMMISSIONER

Jason Wiersma

201 West Kalamazoo Avenue
Kalamazoo, MI 49007

APPLEGATE FARMS NO. 1 NORTH DRAIN

**NOTICE DAY OF REVIEW OF DRAINAGE DISTRICT BOUNDARIES
AND REVIEW OF APPORTIONMENTS**

DATE: Monday, August 29, 2022
TIME: 9:00 a.m. to 5:00 p.m.
LOCATION: Kalamazoo County Building
201 W. Kalamazoo Avenue, Room 105
Kalamazoo, MI 49007
QUESTIONS: (269) 389-9926

The Kalamazoo County Drain Commissioner will hold a Day of Review of Drainage District Boundaries and Apportionments on the above date, time, and location. The Day of Review is an opportunity to review the Applegate Farms No. 1 North Drain Drainage District boundaries and the tentative apportionments of benefit for each parcel and municipality within the Drainage District with the Drain Commissioner or staff member. A map of the proposed Drainage District boundary revisions can be found enclosed with this notice and on the Drain Commissioner's website at: <https://www.kalcounty.com/drain/projects-notices.htm>.

The Drain Commissioner, engineers and/or other staff members will be available to assist individuals throughout the day and make revisions where necessary. There is no need to schedule an appointment for a specific time on the Day of Review. The computation of costs for the Drain will also be available at the Day of Review. Drain assessments are collected in the same manner as property taxes and will appear on your winter tax bill. If drain assessments are being collected for more than one (1) year, you may pay the assessment in full with any interest to date at any time and avoid further interest charges.

Persons with disabilities needing accommodations for effective participation in the Day of Review should contact the Drain Commissioner's Office at the number noted above (voice) or through the Michigan Relay Center at 7-1-1 (TDD) at least 24 hours in advance of the Day of Review to request mobility, visual, hearing, or other assistance.

Comments on the apportionment of benefits may be submitted to the Drain Commissioner in writing before the date of the Day of Review to the Kalamazoo County Drain Commissioner at 201 West Kalamazoo Avenue, Kalamazoo, Michigan 49007 or to zsvoss@kalcounty.com or amwarn@kalcounty.com, or comments may be submitted in writing or verbally at the Day of Review. Comments submitted in advance must be received by the Drain Commissioner prior to the Day of Review to ensure consideration.

The following is a list of any county, township, city, or village to be assessed: Kalamazoo County and Texas Township.

You may appeal the Drain Commissioner's decision to revise the district boundary to the Kalamazoo County Circuit Court within ten (10) days, and you may also appeal the determination of apportionments to the Kalamazoo County Probate Court within ten (10) days.

Jason Wiersma
Kalamazoo County Drain Commissioner

APPLEGATE FARMS NO. 1 NORTH

DRAINAGE DISTRICT

SECTION 14
T03S R12W
TEXAS TOWNSHIP, KALAMAZOO COUNTY



DRAINAGE DISTRICT INFORMATION:

HISTORIC DISTRICT:	26.09 ACRES
REVISED DISTRICT:	20.56 ACRES
LANDS ADDED:	0.00 ACRES
LANDS REMOVED:	5.53 ACRES
DRAIN LENGTH APPLEGATE FARMS NO. 1 NORTH	0.20 MILES

LEGEND

- LANDS REMOVED
- DRAIN ALIGNMENT
- HISTORIC DRAINAGE DISTRICT BOUNDARY
- REVISED DRAINAGE DISTRICT BOUNDARY
- PARCEL LINES
- ROADS
- SECTION LINES
- SECTION NUMBERS
- REFERENCE POINTS

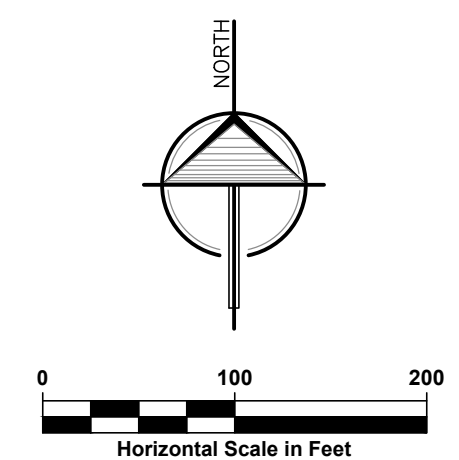
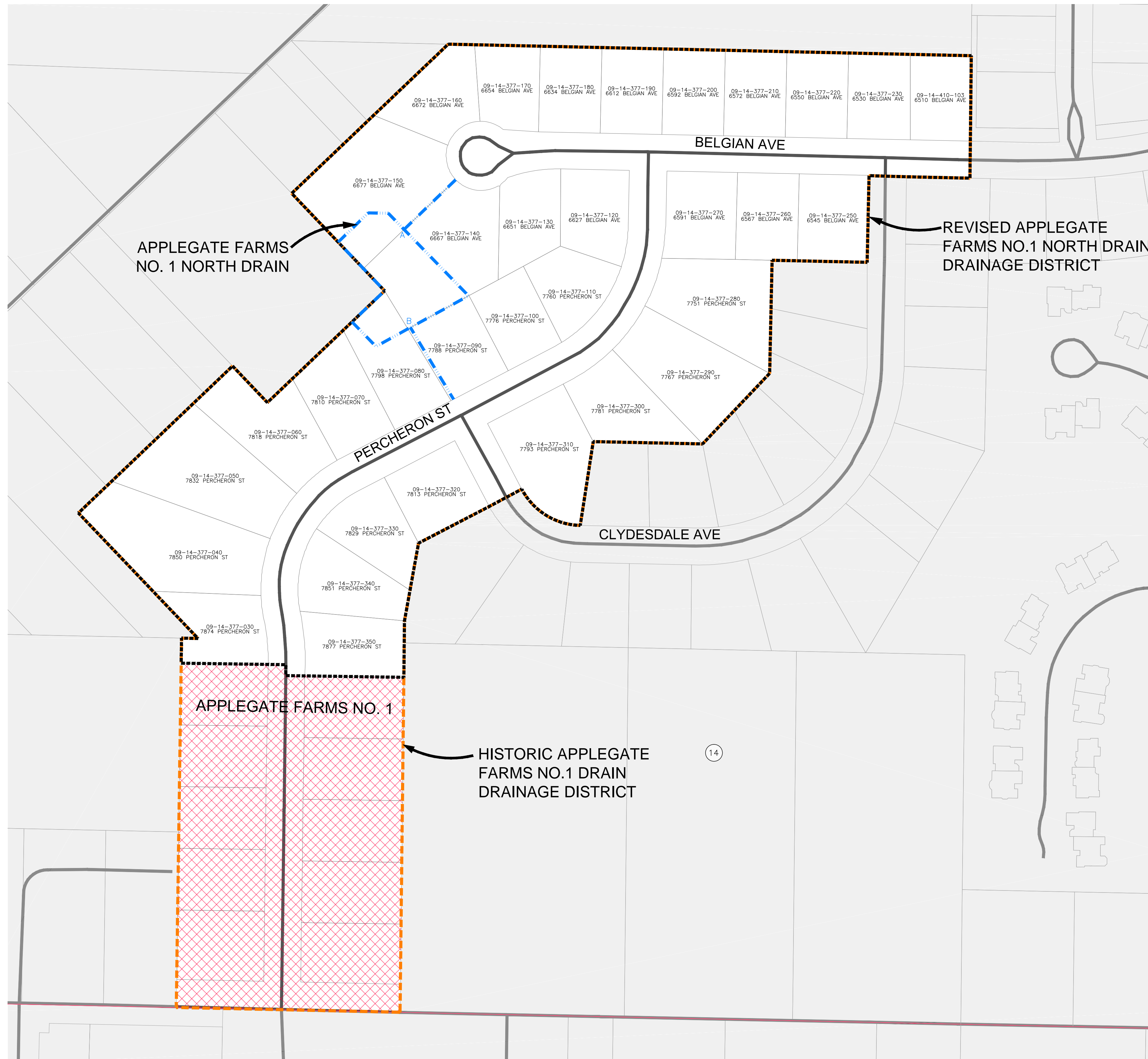

LANDS ADDED/REMOVED MAP

<p>LRE ENGINEERS & SURVEYORS</p>	2121 3 Mile Rd. NW Walker, MI 49544 Ph: 616-301-7888 www.LREMI.com	PROJECT#: 22-013.03
		DRAWN BY: MAC
		DATE: 08/2022
		QA/QC: KJV